

July 7, 1993
334-Ssuscrk.hdm

Introduced by: Pullen
Proposed No.: 93-638

ORDINANCE NO.

11039

1 AN ORDINANCE relating to the annexation of
2 an area known as 334-S to Soos Creek Water
3 and Sewer District for sewer service.

4 STATEMENT OF FACT:

5 1. A notice of intention proposing the annexation of an
6 area for sewer service known as 334-S to Soos Creek Water and
7 Sewer District was filed with the county council effective July
8 7, 1993.

9 2. Soos Creek Water and Sewer District has found the
10 petition for annexation to be sufficient and has, by Resolution
11 No. 0955-S concurred with the proposed annexation.

12 3. Soos Creek Water and Sewer District filed a Declaration
13 of Non-significant Impact dated April 15, 1993, on the proposed
14 annexation.

15 4. The county council held a public hearing on the
16 7th day of September, 1993 and has
17 considered the criteria set forth in R.C.W. 56.02.060.

18 BE IT ORDAINED BY THE COUNCIL OF KING COUNTY:

19 SECTION 1. The annexation of Soos Creek Water and Sewer
20 District of the area known as 334-S and described in Section 4
21 herein is approved. This proposed annexation is consistent
22 with R.C.W. 56.02.060.

23 SECTION 2. The Soos Creek Water and Sewer District is the
24 appropriate entity to serve the area proposed to be annexed.

25 SECTION 3. Completion of this annexation does not
26 constitute county approval or disapproval of any other permits,
27 franchises, certifications, or actions necessary to provide
28 service to this annexation area, nor does it authorize sewer
29 service in any area not designated as a "Local Service Area" by
30 the King County Sewerage General Plan.

1 SECTION 4. The area known as 334-S to be annexed for sewer
2 service is described as follows:

3 That portion of the Northwest Quarter and the Southwest
4 Quarter of Section 25, Township 22 North, Range 5 East,
5 W.M., King County, Washington, described as follows:

6 Beginning at the Northeast corner of the South half of the
7 North half of Southwest Quarter of the Northwest Quarter
8 Section 25;

9 Thence Westerly along the North line of said subdivision,
10 to the West line of the East 660 feet of said subdivision,
11 and the True boundary of Soos Creek Water and Sewer
12 District;

13 Thence continuing Westerly along the North line of said
14 subdivision, to the Northwest corner of said subdivision,
15 also being a point on the West line of said Section 25, the
16 District boundary, and the centerline of 164th Avenue
17 Southeast;

18 Thence Southerly along the West line of said Section 25, to
19 the intersection with the Westerly extension of the South
20 line of Parcel C of King County Short Plat No. 577004,
21 recorded under Auditor's file No. 7708030802;

22 Thence Easterly and Southeasterly along said South line of
23 Parcel C, to the Southeast corner of said Parcel C;

24 Thence Northerly along the East line of said Parcel C, and
25 the East line of the Plat of Mountaintop Lane, as recorded
26 in King County Plats, Volume 87, Page 71, to the centerline
27 of Southeast 264th Street, also being the East-West
28 centerline of said Section 25;

29 Thence along the centerline of said street to the West line
30 of the East 670 feet of the Southwest Quarter of the
31 Northwest quarter of said Section 25;

32 Thence North along said West line to the South line of the
33 North 128 feet of the South 330 feet of the Southwest
34 Quarter of the Northwest Quarter of said Section 25;

1 Thence East along said South line to the West line of the
2 East 660 feet of the Southwest Quarter of the Northwest
3 Quarter of said Section 25;

4 Thence North along said West line to the True Point of
5 Beginning.

6 INTRODUCED AND READ for the first time this 23rd day
7 of August, 1993.

8 PASSED this 20th day of September, 1993

9
10

KING COUNTY COUNCIL
KING COUNTY, WASHINGTON

11
12
13

Cynthia Sullivan
VICE Chair

ATTEST:

14
15

Janet Masuo
Deputy Clerk of the Council

16

APPROVED this 1st day of OCTOBER, 1993

17
18

David Hill
King County Executive

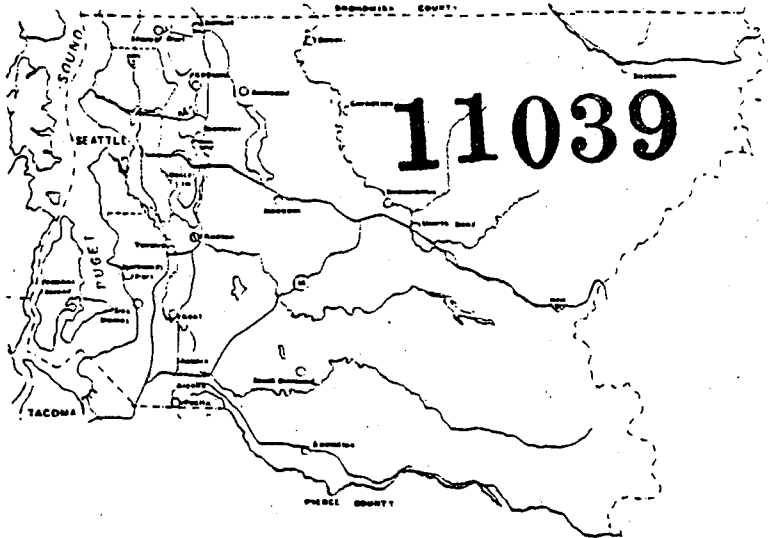

**SOOS CREEK WATER AND SEWER DISTRICT
PROPOSED ANNEXATION 334-S**

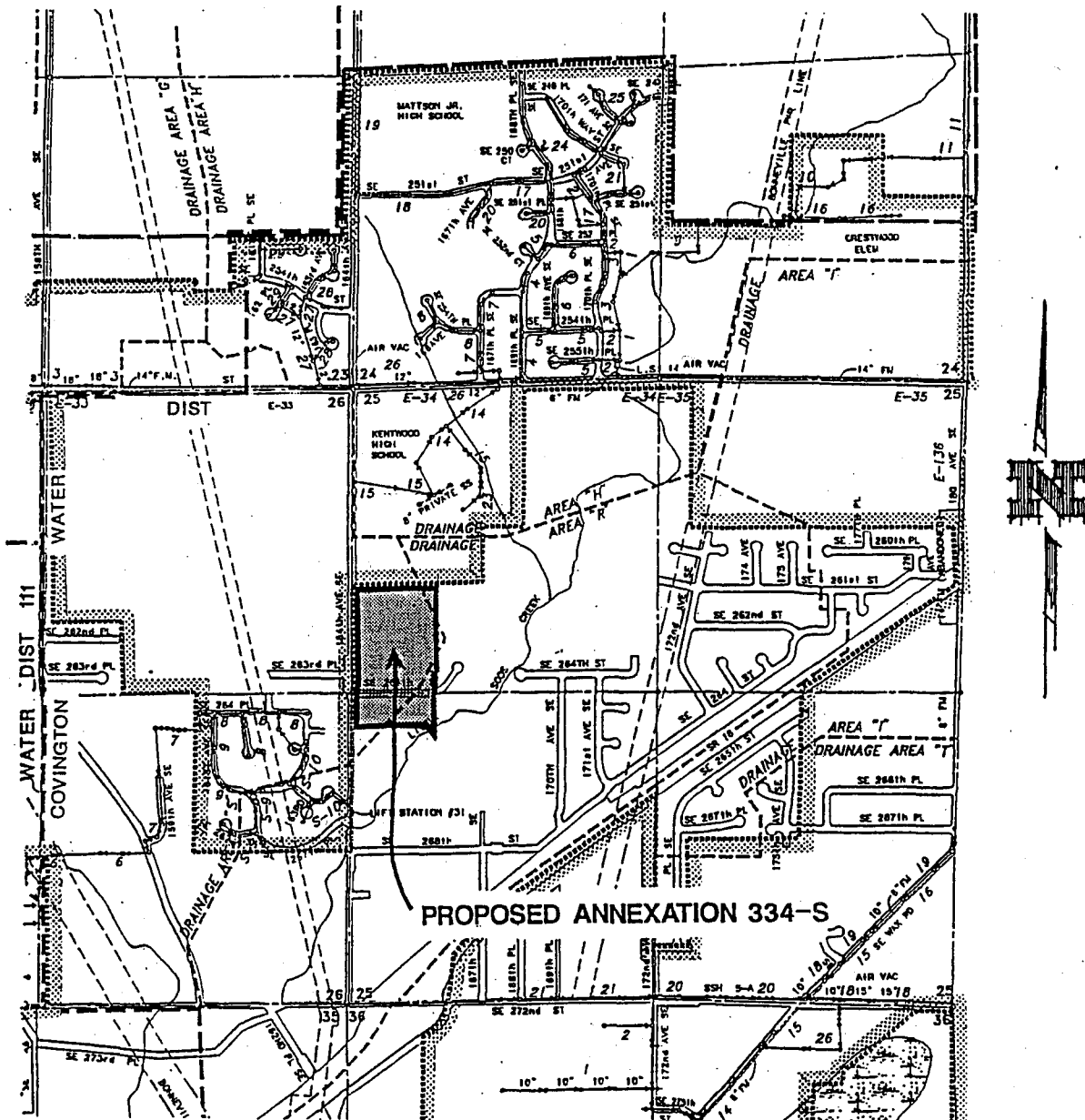

**PROPOSED ANNEXATION 334-S
(SEWER SERVICE AREA)**

ANNEXATION TO _____
 COUNCIL DISTRICT _____
 KING COUNTY ORD. NO. _____
 CITY ORD. NO. or DIST. RES. NO. _____

RECEIVED
 93 JUL -7 PM 2:17
 CLERK
 KING COUNTY COUNCIL